



MERCEDES

vehicle specific integration solutions

COMPATIBILITY chart

Vehicle	Compatible Integration			
	Universal	CDC radio	Navi. radio	non-Navi. radio
C-Class				
2005 - 2007	FMRDS		MB-42 ²	MB-43 ²
1999 - 2004	FMRDS	D2B ^{1,2}		
CL-Class				
2004 - 2006	FMRDS		MB-42 ²	MB-43 ²
2000 - 2003	FMRDS			
CLK-Class				
2005 - 2009	FMRDS		MB-42 ²	MB-43 ^{2,3,4}
1999 - 2004	FMRDS	D2B ^{1,2}		
CLS-Class				
2005 - 2008	FMRDS		MB-42 ²	
E-Class				
2003 - 2008	FMRDS		MB-42 ²	MB-43 ²
G-Class				
2007 - 2009	FMRDS		MB-42 ²	MB-43 ^{5,6}
1999 - 2005	FMRDS	D2B ^{1,2}		
GL-Class				
2007 - 2008	FMRDS		MB-42 ²	MB-43 ²
Maybach				
2004 - 2008	FMRDS		MB-42 ²	
ML-Class				
2006 - 2008	FMRDS		MB-42 ²	MB-43 ²
2001 - 2005	FMRDS	D2B ^{1,2}		
R-Class				
2006 - 2008	FMRDS		MB-42 ²	MB-43 ²
S-Class				
2004 - 2006	FMRDS		MB-42 ²	MB-43 ²
2001 - 2003	FMRDS	D2B ^{1,2}		
SL-Class				
2006 - 2008	FMRDS		MB-42 ²	MB-43 ²
2005	FMRDS			MB-43 ²
2001 - 2004	FMRDS	D2B ^{1,2}		
SLK-Class				
2005 - 2008	FMRDS		MB-42 ²	MB-43 ²
1999 - 2004	FMRDS	D2B ^{1,2}		

Abbreviation Note:

i-Mercedes-D2B kit ↔ **D2B**
mo-Mercedes-42 kit ↔ **MB-42**
mo-Mercedes-43 kit ↔ **MB-43**
FMRDS & FMRDS USB-PRO ↔ **FMRDS**



- For the most updated information on **MB-42/43**, please visit our website at www.diceelectronics.com
- 1. Only compatible with Audio 10, Audio 30, COMAND 2.0, or COMAND 2.5 radio. Audio is non-nav, COMAND is navigation.
- 2. External CD-Changer must be disconnected.
- 3. 2003 may be compatible. Verify head unit type before ordering.
- 4. Early 2005 cars may be D2B. Verify closely 2005 car is either COMAND MOST or Audio 20/50 for compatibility.
- 5. Special (long) harness maybe needed for G-Wagon if mounting in rear of the vehicle, particularly if equipped with SAT radio.
- 6. For listed 2009 models, please make sure it is COMAND or Audio 20/50 and not the new NTG2.5 or Audio30 headunits. Mercedes could change over to the new head-units mid-production but for these models they are still fitting the old COMAND and Audio20/50.

FAQs Before Purchasing the Kit Integration for iPod

D2B MB-42/43 Will my factory 6-CD changer be disabled with this unit installed?

Yes, the factory CD changer must be disabled to have the iPod kit integrated into the factory radio system.

MB-42 What will my navigation screen display while operating my iPod?

The display will allow you to see and browse Playlists, Artists, Albums, Genre, and Songs within these categories for mo-Mercedes-42 kit.

D2B MB-42/43 Can I install this unit myself?

It is recommended that this integration kit be installed by a professional that has experience installing fiber-optic systems. It can be installed directly behind the navigation unit, or at the CD-changer location.

MB-42/43 Can I set the unit to a mode where I can use my iPod directly?

Yes, through the radio you can set up the unit for iPod control, and the iPod becomes unlocked, but this disables text and browsing controls through the radio.

Installation Tips / Check List Integration for iPod

For **D2B** kit, if the CD changer is present in the vehicle, please follow the steps below:

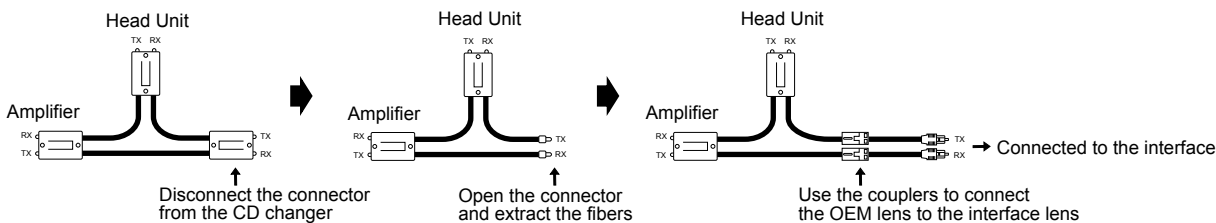

- D2B MB-42/43** Installation can sometimes easily be done at the CD changer location. Since the CD changer is disconnected anyway, the integration can take place there.

Content Identifier Integration for iPod

for i-Mercedes- **D2B** kit:

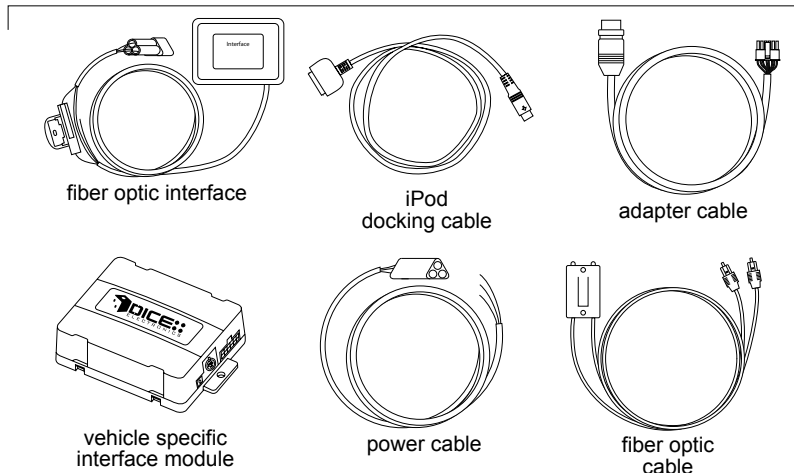

for mo- **Mercedes-42/43** kit

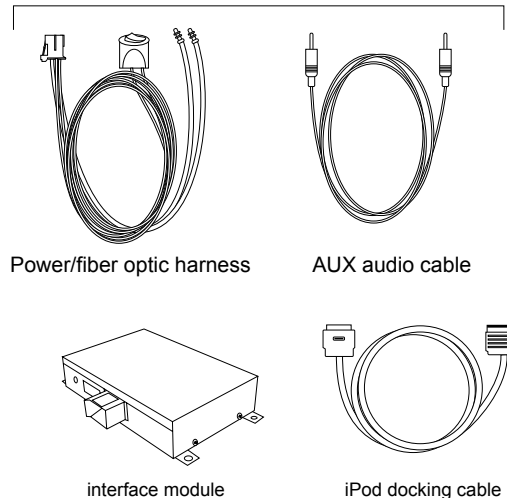

About Dip Switch Settings Integration for iPod

The configuration switches located on the DICE module are used to set the operation of the interface by the installer. Incorrect dip switch settings may cause the DICE interface not to work properly or not to operate at all. **Disconnect the vehicle harness from module and cycle ignition off for 50 seconds after changing the switches!**

for i-Mercedes- **D2B** kit:

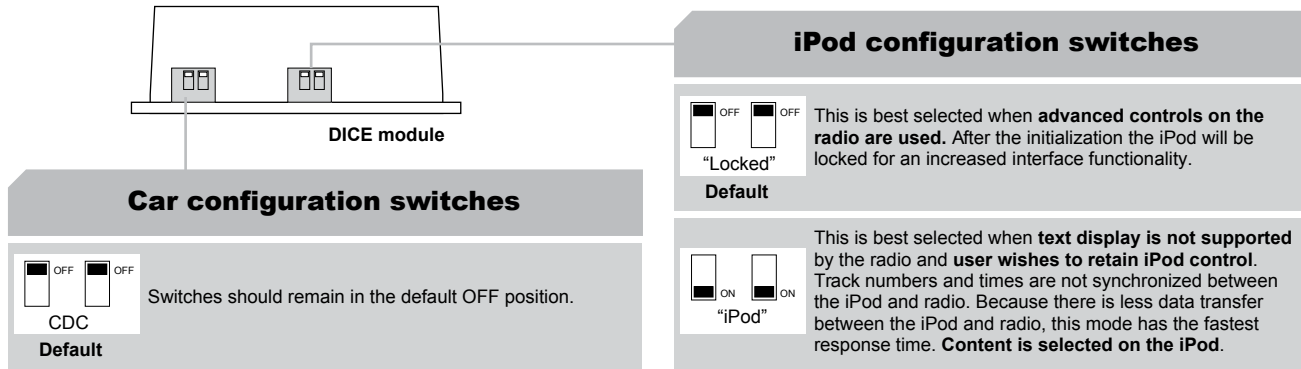

MERCEDDES Integration for iPod

Connection Diagram Integration for iPod

Note: further instruction in the installation tips/check list

for i-Mercedes- **D2B** kit:

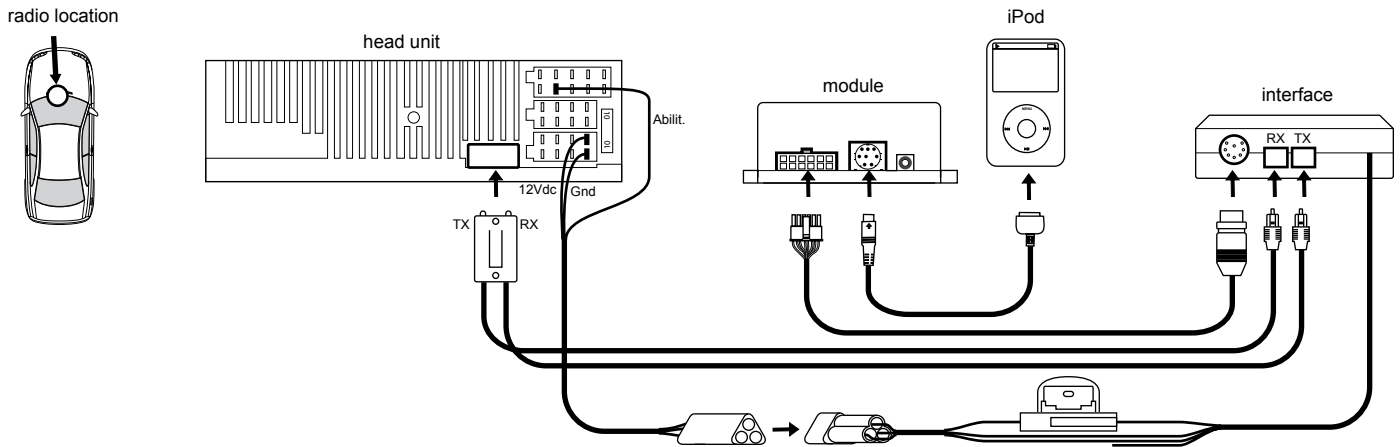

for mo- **Mercedes-43** kit

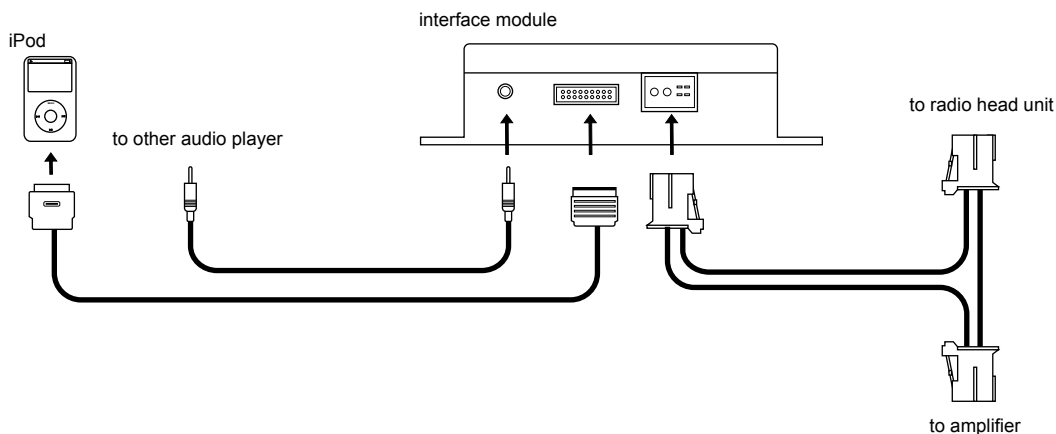

MOST navigation radio

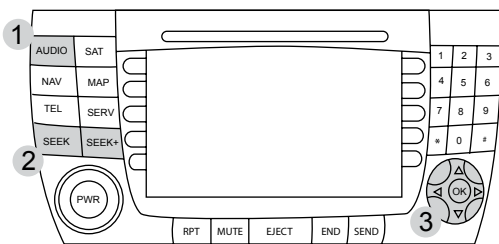

- 1 Brings up audio sources on screen. Select CDC.
- 2 Press to change track.
- 3 Use up/down arrows to scroll through menu options. Use left/right arrows for RW/FFW

Mercedes Specific Technical Notes Integration for iPod

for i-Mercedes- **D2B** kit:

Problem	Solution
Cannot select the interface from the radio.	Make sure dip switches are set correctly according to the dip switch setting diagram. Use CD button to access the DICE unit. Also check connections, making sure power, ground, and wake-up wires are all attached/tapped in properly.
There is no audio from the iPod source.	Try resetting the iPod and insure that the iPod cable connections are tightly connected.
Audio is present, but controls from radio/steering wheel do not operate iPod.	The unit may be stuck in Auxiliary mode. Select DISC 5 and set to Track 01. Switch back to DISC 1 and try changing track.
The iPod does not charge.	Check all connections. Try resetting the iPod and make sure iPod charges while connected to computer or wall charger.
Music is distorted or sound level is too low.	Make sure all EQ and BASS boost options are turned off on your iPod.
Pressing the next track button only cuts out the audio for a brief second and continues on the same song.	Double-click the next track button or hold the next track button for a little longer and it will skip to the next song.
Unit is connected directly to head unit, but is not being detected.	Make sure the factory CD-Changer (if equipped) is disconnected and by-passed with the fiber-optic cabling.

for mo- **Mercedes-43** kit

Problem	Solution
My iPod does not charge or synchronize with the integration system.	Reset the iPod by holding down the Menu button and center button together until the Apple logo appears on screen. New models of iPod may not charge because of altered charging method (4th gen. Nano, 2nd gen. Touch, 3G iPhone).
The navigation screen does not come up with the regular menu, it just stays on the "Mercedes" display and will not operate anything.	This may be because the fiber-optic in and out cables are put in backwards. Just swap the two fiber optic cables in the connector from the DICE kit and the flow of light should be back to normal.
Where do the orange and brown wires need to be attached to?	The orange wire must be connected to Constant 12V power, and the brown wire needs to be attached to a ground source.
My navigation system comes on and the sources are operable, however I cannot consistently operate or access the CD-Changer source.	Make sure the factory CD-changer is disconnected and the fiber-optic cables that were disconnected from it are connected to our unit properly.