

Compatible iPod & iPhone models

Model	Firmware / OS Version
1G nano	1.3.1
iPod 5G	1.3
2G nano	1.1.3
iPod classic	1.1.2
3G nano	1.1.3
iPod touch	iOS 3.1.3
iPhone	iOS 3.1.3
iPhone 3G	iOS 4.2.1
4G nano	1.0.4
120 GB classic	2.0.1
2G touch	iOS 4.3
iPhone 3GS	iOS 4.3

Model	Firmware / OS Version
160 GB classic	2.0.4
5G nano	1.0.2
3G touch	iOS 4.3
iPhone 4	iOS 4.3
4G touch	iOS 4.3
6G nano	1.0

MediaBridge kit contents

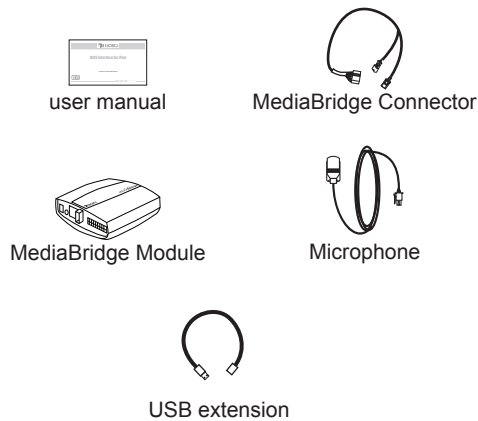

MEDIA BRIDGE

MB-1500-BMW integration solution for BMW/MINI COOPER vehicles

Installation Guide/User Manual

DICE logo is a trademark of DICE Electronics, LLC. SiriusConnect, Sirius and XM logos are trademark of SiriusXM. The Made for iPod logo is a trademark of Apple Inc. Apple iPod is not included in the package. For our detailed terms and conditions please visit our website at www.diceelectronics.com. MB-1500-BMW REV. 009011

Firmware update

- STEP 1: Disconnect the MediaBridge module from the vehicle.
- STEP 2: Download and install necessary software from www.diceelectronics.com
- STEP 3: Open software to follow instructions for updating MediaBridge unit.
- STEP 4: Plug in MediaBridge via mini USB cable and update.
- STEP 5: Disconnect and reinstall the unit into the vehicle.

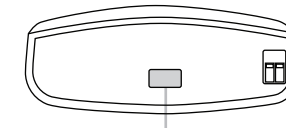

Mini USB port for software update

Dip switch setting

NOTE: 4:3 (small screen) navigation radios require special firmware available from DICE Electronics support.

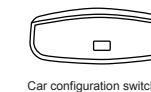

Car configuration switches			
BMW Business CD Radio		BMW Navigation Radio	
OFF	OFF	ON	OFF
Recommended for single line display or non-navigation radio system. (Mini, 3-series, Z3, Z4, X3)		For 16:9 (wide screen) navigation radio system.	
MINI with Navigation		BMW MID Radio	
ON	ON	OFF	ON
For 4:3 (small screen) navigation* and MINI Cooper with Navigation.		For non-navigation radio system on BMW 5, 7, X5 series MID units.	

4. Connect both 3-pin and 6-pin cables to the DICE BMW Interface Harness.

ATTENTION! There are two 3-pin connectors presented in the vehicle. During installation, make sure that the 3-pin connector from the vehicle **DOES NOT** have a brown wire in the middle! The 3-pin connector of the phone pre-wiring looks identical to the 3-pin connector of the CD changer pre-wiring. Locate and use the correct 3-pin cable with the brown wire on the outside! Incorrect connection will result in permanent damage to the unit and will not be covered by warranty!

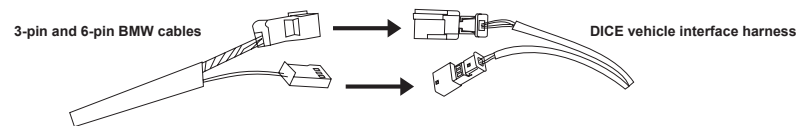

- 5. Route the interface cable to the front of the vehicle. Fold down rear seats (if applicable) and route the extension cable through the rear seat bottom cushion. Route the remainder of the interface cable (ie. under the door sill or under the driver's seat) to a location where the module can be easily accessed in the future.
- 6. Make sure you have set the DIP switches on the MediaBridge as specified on page 3.
- 7. Connect the BMW interface cable, USB Cable and SIRIUS Connections (if applicable) to the MediaBridge module and double-check all connections. See page 4 for the connection diagram.
- 8. Test the installation.
- 9. Replace any trim, carpeting or panels that were removed during installation.

Installation

Note: Installation should only be performed by a qualified professional. Beware of sharp edges to avoid injury and exercise caution when removing trim pieces as they may break. The module should be placed in an accessible location, such as the glove box, consoles, under the front seats or in some cases in the trunk to allow USB/SIRIUS/AUX cables to be connected. The module firmware may need to be updated periodically and must be removed from the vehicle and connected to a computer to apply the update.

1. Disconnect both battery terminals. These cables must be disconnected during installation to ensure proper initialization of the DICE module when it is connected. **This step is REQUIRED for proper operation of the DICE module!**
2. Access the CD changer cable. The location of this cable varies by BMW model.
3. **If the vehicle you are performing the installation on has DSP, refer to the instructions included with the DSP kit.** Locate both the 3-pin & 6-pin connectors. If the vehicle has a factory CD changer installed, the 3-pin & 6-pin cables will be connected to it and will need to be disconnected. If there is not a CD changer installed the cables will be bundled and may be tucked away behind carpeting.

! Some vehicles will have the CD changer wiring in a protective sheath which may make it more difficult to locate. **Non-US models** may not be pre-wired for a CD changer, and require an additional harness from BMW to be connected.

Connection diagram

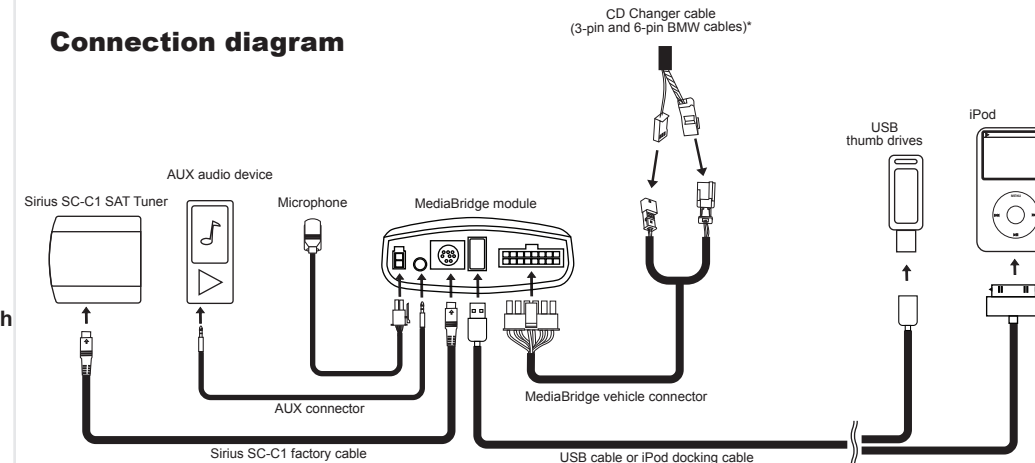

* If coax is present, DSP kit may be required. For installation, refer to DSP supplement

Getting started

Press **MODE** or **CD** to select MediaBridge.

Audio Source Selection*:

Use the **◀ ▶** within the first 5 seconds to cycle between AUX > USB > Bluetooth > SIRIUS while in DISC 1

*USB is only selectable if a USB flash drive or iPod is attached. SIRIUS is only selectable if a SIRIUS tuner is attached.

MediaBridge Interface Settings (within first 5 seconds of entering MediaBridge Emulation):

- Select DISC 2 to set charge time after ignition off (for iPod).
- Select DISC 3 to change base volume.
- Select DISC 4 to set up scrolling text option.
- DISC 5 - no feature assigned.
- Select DISC 6 to view MediaBridge firmware version. (Select DISC 1 to apply settings and resume audio playback.)

iPod hold ON	Text display	Radio control	iPod control
	All	✓	✗

Before connecting the iPod to the MediaBridge module, turn the hold switch **ON** to fully control and browse the songs from factory radio. The iPod is locked in this state.

iPod hold OFF	Text display	Radio control	iPod control
	No Playlist / Artist / Album name shown on the radio	limited	✓

Before connecting the iPod to the MediaBridge module, turn the hold switch **OFF** to fully control and browse the songs from iPod. The factory radio control and browsing capabilities are limited.

Note: Changing the hold switch on iPod to ON/OFF must be done **prior** to connecting the dock cable.

Controlling the MediaBridge from select BMW and Mini radios

NOTE: 99-03 3-Series and Z3 will require double clicking buttons when text is displayed.

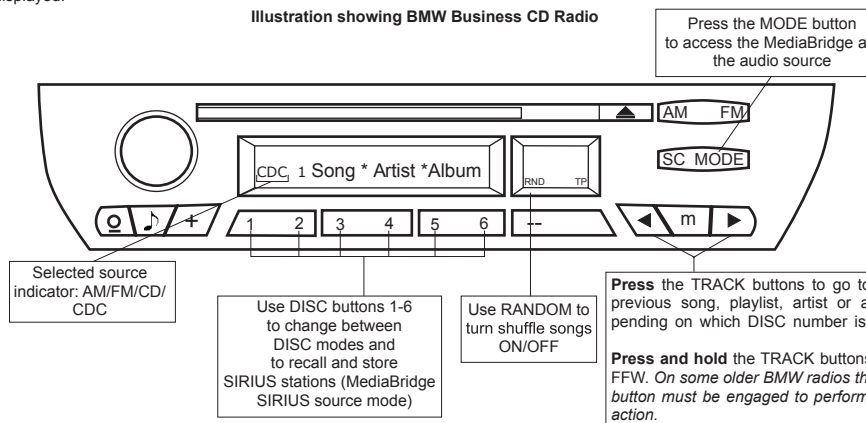

- Use DISC buttons 1-6 to change between DISC modes and to recall and store SIRIUS stations (MediaBridge SIRIUS source mode)
- Use RANDOM to turn shuffle songs ON/OFF
- Press the TRACK buttons to go to the next/previous song, playlist, artist or album (depending on which DISC number is selected).
- Press and hold the TRACK buttons to RW or FFW. On some older BMW radios the **m** button must be engaged to perform the same action.

Illustration showing BMW 16:9 navigation radio

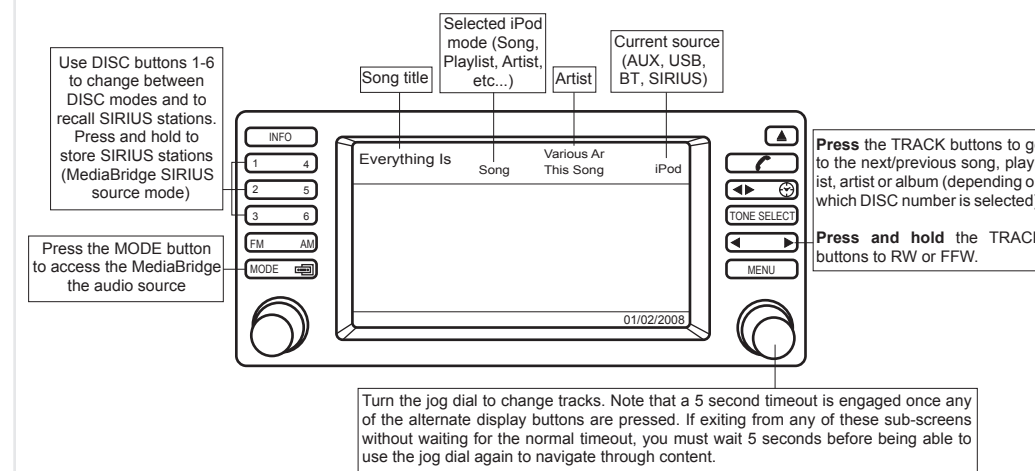

- Use DISC buttons 1-6 to change between DISC modes and to recall SIRIUS stations. Press and hold to store SIRIUS stations (MediaBridge SIRIUS source mode)
- Press the MODE button to access the MediaBridge the audio source
- Press the TRACK buttons to go to the next/previous song, playlist, artist or album (depending on which DISC number is selected).
- Press and hold the TRACK buttons to RW or FFW.
- Turn the jog dial to change tracks. Note that a 5 second timeout is engaged once any of the alternate display buttons are pressed. If exiting from any of these sub-screens without waiting for the normal timeout, you must wait 5 seconds before being able to use the jog dial again to navigate through content.

Illustration showing Mini Navigation radio

Song/Artist/Playlist displayed here

Unlocked iPod Unlock Song GPS

33°48' 19" North
118°10' 25" West
Altitude 280 ft

78°F

Press the MODE button to access the MediaBridge as the audio source

Press the TRACK buttons to go to the next/previous song, playlist, artist or album (depending on which DISC number is selected).

Press and hold the TRACK buttons to RW or FF. On some older BMW radios the **m** button must be engaged to perform the same action.

Selected source indicator: AM/FM/CD/CDC

Used to store stations to Presets 1-5.

Turn DIAL for next/previous track.

Press DIAL to store SIRIUS station presets (SIRIUS source mode; see page 24).

On Mini navigation radios, the RND button is used to toggle between Menu and Text modes.

Text Mode (RND enabled): Displays text from the MediaBridge such as Song/Artist/Playlist titles.

Menu Mode (RND disabled): Displays the default navigation and vehicle menu screens.

Use DISC buttons 1-6 to change between DISC modes and to recall and store SIRIUS stations (SIRIUS source mode).

MODE MENU RND

FM AM CDC 1 TR01

1 2 3 4 5 6

DISC 1 → SONG NAME 1 → SONG NAME 2

DISC 2 → PLAYLIST 1 → PLAYLIST 6

DISC 3 → ARTIST 1 → ARTIST 3

DISC 4 → ALBUM 1 → ALBUM 7

DISC 5 → PODCAST 1 → PODCAST 9

DISC 6 → AUDIOBOOK 1 → AUDIOBOOK 4

Controlling the MediaBridge iPod source

The MediaBridge integration kit features content browsing. After connecting the iPod, select the desired browsing mode by selecting the appropriate DISC. Press the SEEK button or turn the TUNE dial repeatedly to browse contents. 1 second after releasing the button, your selection is executed. The browsing function below is illustrated in the "Track" field.

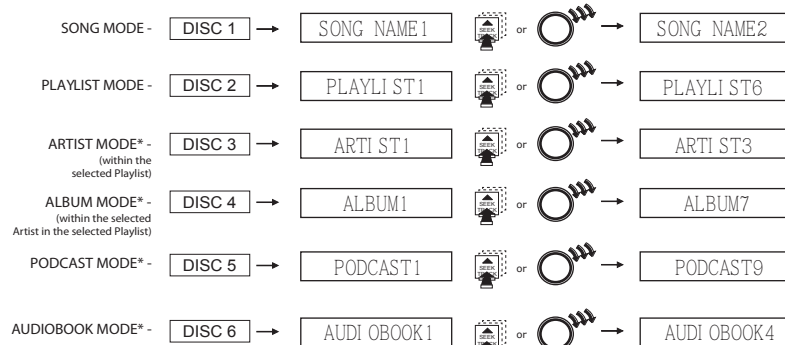

*Only available when iPod is locked. When iPod is unlocked the radio will only display song titles.

Controlling the MediaBridge SIRIUS source

The MediaBridge integration kit features SIRIUS connectivity. Use the TRACK buttons or jog DIAL to browse between subscribed channels.

To store a subscribed channel to memory:

- **Single line radio:** Tune to desired station. Press RANDOM button and select which DISC button (preset 1-6) to save to. Press RANDOM button once more to store the station.
- **Navigation radios:** Tune to desired station. Press and hold the desired DISC button (preset 1-6) to save as preset.
- **Mini navigation radio:** Tune to desired station. Press jog DIAL, press desired DISC button (1-6), press DIAL to save.

To recall a memorized channel: Simply press the desired DISC (preset 1-6).

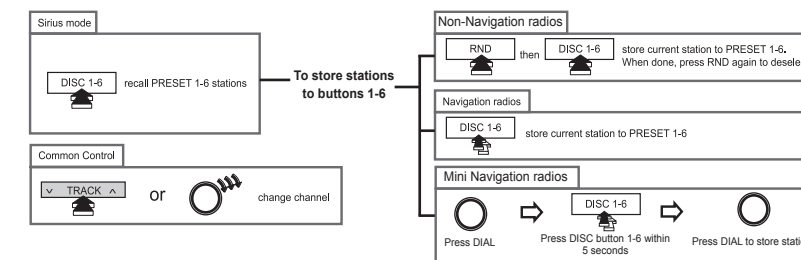

NOTES: If a SIRIUS CONNECT compatible tuner is not detected, then a "No Tuner" vehicle message is displayed. Go to Channel 000 to view the SIRIUS Tuner ID for activation. The 12 digit SID display format is shown in two parts as SID "123456" followed by "-789ABC".

Bluetooth & MAT (Music Announcer Technology) configuration

To alter voice announcement and Bluetooth pairing settings select **Bluetooth** as your audio source, press the preset button that corresponds to the feature you want to configure, and then use **track or channel UP/DOWN** to browse through configuration options:

- PRESET/DISC 1, 2 or 3 should be selected if you want to control Bluetooth audio streaming playback.
- PRESET/DISC 4 controls the Autoconnect feature. Available options are Enable and Disable. This controls whether or not the MediaBridge will reconnect automatically when phone becomes disconnected. Only the most recently paired device will be reconnected automatically.
- PRESET/DISC 5 controls the paired devices memory. There is only one option. Tune or change tracks to clear the listing of paired devices with the MediaBridge.
- PRESET/DISC 6 controls MAT setting. Available options are Default, Extended, Phone only, and Off (refer to the chart below).

Options	Function
Default	Reset MAT back to factory default configuration
Extended	Turn on ALL MAT feature
Phone only	Turn on the phone relative MAT only
Off	Turn off MAT completely

Pairing MediaBridge with your cell phone via Bluetooth

1. Turn on the Bluetooth feature on your cell phone
2. Select MediaBridge as your audio source from your radio, then select Bluetooth mode
3. Search device from your cell phone
4. Select MediaBridge from device list and enter password "0000" to connect

Note: MediaBridge is only discoverable for first 60 seconds after selecting MediaBridge as your radio's audio source. Bluetooth devices remain paired 30 seconds after exiting MediaBridge mode, within this time active audio streams and phone calls aren't audible on the phone but can be resumed by re-entering MediaBridge mode

Answering / making a phone call

- To answer an incoming call, press the button that tunes to the next track or channel
- To reject an incoming call or terminate an active call, press the button that tunes to the previous track or channel
- To make an outgoing call, dial on the phone like you would normally

Phone calls interrupt any music / audio that is currently playing on the radio while MediaBridge is the selected audio source.

Playing music from a cell phone through MediaBridge via Bluetooth

1. Enter Bluetooth mode on MediaBridge
2. Make sure your cell phone is paired with MediaBridge
3. Select and play a song from your cell phone's music player

Note: Some cell phones require you to manually select the option to play music via (A2DP) Bluetooth Streaming. Song information is shown on the radio display if your phone has AVRCP1.3.

4. Use Track UP/DOWN to skip tracks / FF / RW songs on the AVRCP compatible phone.

USB memory operation



- Select DISC 1, then use the track buttons to change from song to song.
- Select DISC 2-6 to browse Folders and use the track buttons to navigate through the folders on your USB flash drive.
- The MediaBridge unit will recognize the first 8 levels of folders, with up to 200 accessible folders within each folder. Only the first 1000 files will be read in each folder, the rest will be ignored.
- Songs play in the order they were added to the flash drive.
- Use the Random feature on radio to shuffle all songs on the flash drive. This may take a long time to complete if the flash drive is more than 4GB.

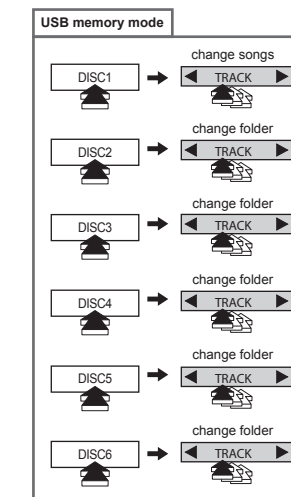

Troubleshooting

Problem	Solution
iPod does not charge.	Check all connections. See if iPod charges while connected to computer or wall charger. You may need to reset the iPod.
Music is distorted or sound level is too low with iPod connected.	Make sure all EQ and BASS boost options are turned off on your iPod. You can set audio base level in DISC 3, see page 6.
Why is the interface not controlling the iPod/USB drive?	Please make sure that the USB connection is not loose. Make sure that an iPod case is not preventing the dock connector from being fully seated. Disconnect and reconnect the device. If iPod is not responding please try resetting it. USB device must also be FAT16/32 format and contain supported MP3, WMA or AAC content.
Sirius tuner can't be selected.	Check for proper connection to the mini DIN 8 receptacle. Make sure that the connector pins are not bent. Make sure to select SIRIUS in Audio Source Selection (refer to page 6).
Why does the radio display show "EMPTY/STOP" and no music plays?	USB iPod: the end of a playlist or selection has been reached. Select a new playlist from DISC2. USB Memory: There are no supported audio files on the flash drive.

Problem	Solution
No audio from iPod source.	Reset the iPod. Verify proper connection to iPod/interface. Check for compatibility. Older iPod models don't support USB audio. Hold switch must be on for 5th generation iPod video.
Cannot select the interface.	Verify unit is trying to be accessed as the CD-changer source. With ignition off, disconnect vehicle harness from module for a minute, verify connections and reconnect.
Radio/ steering wheel controls do not operate iPod.	Reset iPod and make sure the most recent iPod firmware is installed. Check vehicle user manual on how steering wheel controls work, long presses may toggle alternate function.
Why does category read "PRESELCTD"?	Playback of content selected on the iPod before connected to the interface continues until new content is selected.
What size of USB flash drive should I use?	Large capacities are supported, however up to 4GB is recommended for optimal user experience.
Why does the message "iPod UNLOCKED" display on screen?	When the MediaBridge is playing iPod music in UNLOCKED mode, browsing mode information isn't available so the "iPod UNLOCKED" notification is shown. To view song information return to Song mode (Preset 1). To view information associated with browsing modes, ensure the iPod's hold button is set before connecting it to MediaBridge.

Disclaimer and warranty

Important disclaimer, please read!

Unauthorized reproduction or reverse engineering is strictly prohibited! Intellectual property included is distributed under specific license agreement with respective owners and is licensed only, not sold. No warranty, explicit or implied, is stated. Neither DICE Electronics, LLC., nor any of its agents, distributors, dealers or vendors shall be liable for damages.

IN NO EVENT SHALL DICE ELECTRONICS' LIABILITY EXCEED THE PRICE PAID FOR THE PRODUCT FROM DIRECT, INDIRECT, SPECIAL, INCIDENTAL, OR CONSEQUENTIAL DAMAGES RESULTING FROM THE USE OF THE PRODUCT, ITS ACCOMPANYING SOFTWARE OR ITS DOCUMENTATION.

Warranty and Support

Products carry a 90 day limited warranty that protects you from defects in material and workmanship of products sold by DICE Electronics, or its authorized agents, distributors and dealers. The warranty period begins the day a product is purchased by the end user. Products found to be defective during the warranty period will either be repaired or replaced by DICE Electronics at no charge unless warranty is void. Unauthorized attempt of repair or alteration of the product in any way immediately voids this warranty. Warranty does not extend to cosmetics or finish. A DICE product specialist must determine that defect is present in the product and issue an RMA. Be sure that all wiring is connected as described in the user manual and all related equipment is functioning properly. DICE Electronics disclaims any liability for other incurred damages resulting from product defects. Any expenses in the removal and reinstallation of products are not covered by this warranty.

If experience any problems or need help, please contact your local dealer or call 888-342-3999, or visit our support site at <http://www.diceelectronics.com/support>.